

SNOW REMOVAL

Sidewalks next to and around individual homes are the individual homeowner's responsibility to clear, including sidewalks on the side of the home and around mail box if on your lot. Builders in the area that own a lot or several lots are responsibility for the snow removal on the walks around their lot/lots.

Streets are the responsibility of the Town of Windsor. If there are areas of concern with regards to the streets, please contact the Town of Windsor at 970 - 674-2400 or go to their web site at www.windsorgov.com. The Town of Windsor code enforcement phone number if needed for snow removal issues is 970-674-6400.

Perimeter sidewalks and sidewalks adjacent to the **Windshire Park Metro Districts** common areas/open space are generally the responsibility of **Windshire Park Metro Districts**.

The District will send out maintenance crews to remove snow within 24 hours of the last snow fall. Snow service operations cannot eliminate all dangerous/slippery conditions on the property. Slippery conditions are an inherent danger in all snowy or icy areas, whether serviced or not. **Please be careful.**

In the event of significant snow fall, **Windshire Park Metro District** encourages neighbors to help one another if at all possible. Neighbors that worked together are able to clear a path in the main streets that allows them to get out of the community sooner than others. We would encourage homeowners to help others when possible.

If there are any questions regarding the snow removal operations within **Windshire Park Metro Districts** please contact **Windshire Park Metro District** at **970-377-0609**, or check our snow removal map on our web site at www.windshireparkmetrodistrict.com

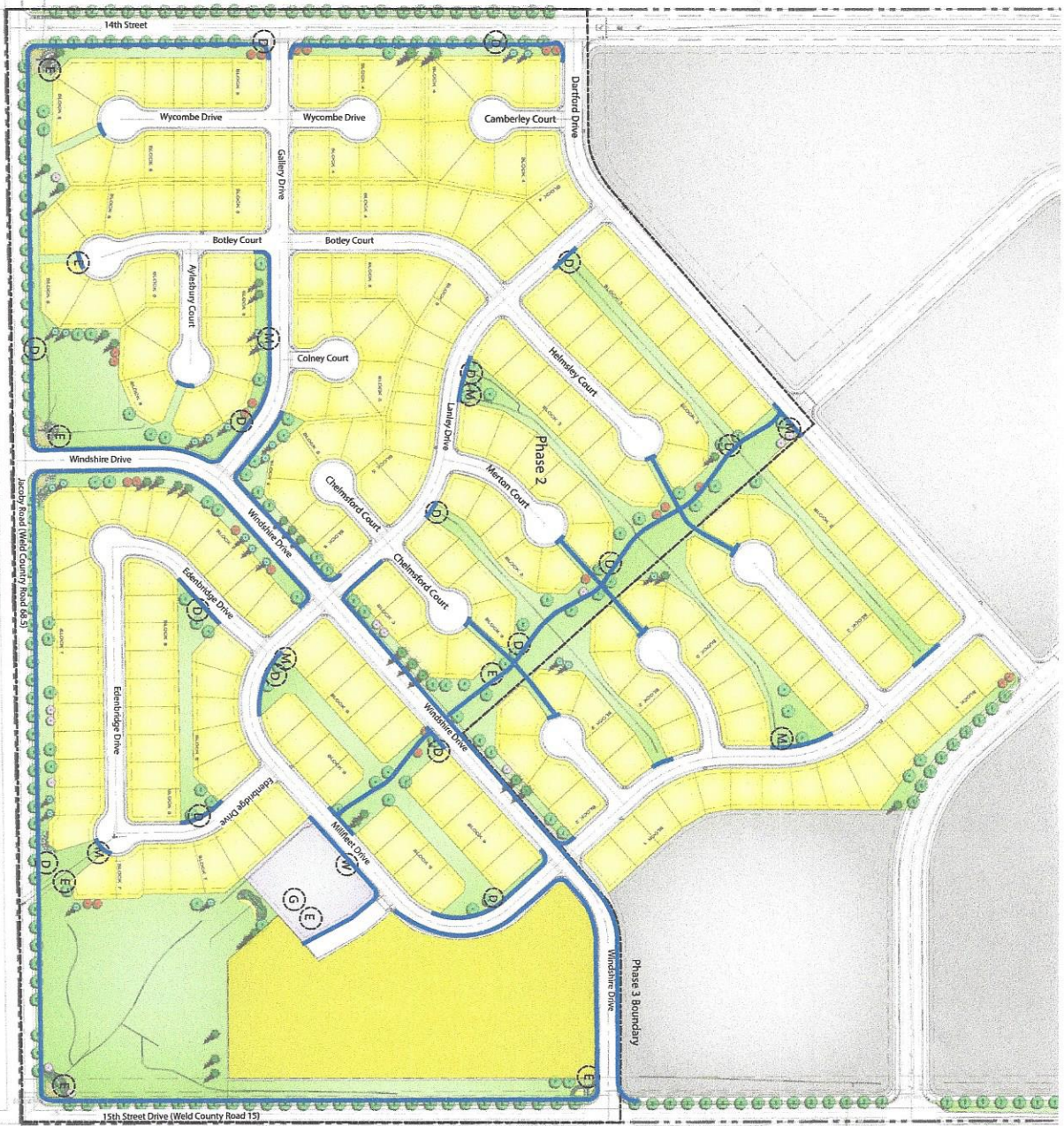

- E Electric
- D Dog Station
- M Mail Box
- G Gas
- W Water
- R Snow Removal

Streets: SNOW REMOVAL is the responsibility of the Town of Windsor.

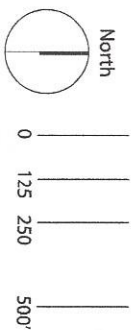

WINDSHIRE PARK
MERCER DISTRICT